

INSTALLATION AND USER'S MANUAL

COOKER HOOD

REINA

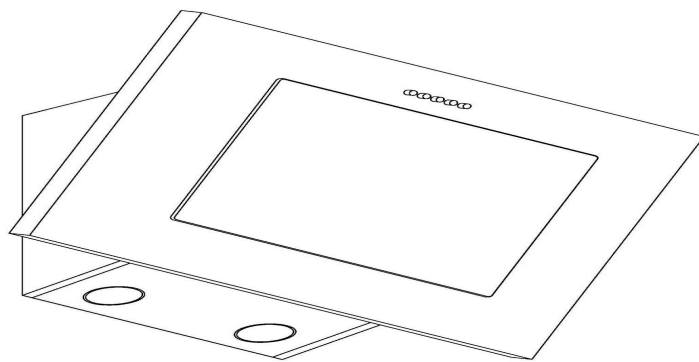

INTRODUCTION

Thank you for choosing this cooker hood.

This instruction manual is designed to provide you with all required instructions related to the installation, use and maintenance of the appliance. In order to operate the unit correctly

and safety, please read this instruction manual carefully before installation and usage.

SAFETY PRECAUTION

- Important! Always switch off the electricity supply at the mains during installation and maintenance such as light bulb replacement.
- The cooker hood must be installed in accordance with the installation instructions and all measurements followed.
- All installation work must be carried out by a competent person or qualified electrician.
- Please dispose of the packing material carefully. Children are vulnerable to it.
- Pay attention to the sharp edges inside the cooker hood especially during installation and cleaning.
- When installing the cooker hood, make sure that the following recommended distances between the top of cooker and the lowest part of the cooker hood are observed:
 - Gas cookers: 70 cm
 - Electric cookers: 70 cm
 - Coal or oil cookers: 80 cm
- Make sure the ducting has no bends sharper than 90 degrees as this will reduce the efficiency of the cooker hood.
- Cooker hood is for domestic use only.
- Always put lids on pots and pans when cooking on a gas cooker.
- Do not try to use the cooker hood without the grease filters or if the filters are excessively greasy!
- When in extraction mode, air in the room is being removed by the cooker hood. Please make sure that proper ventilation measures are being observed. The cooker hood removes odours from room but not steam.
- There shall be adequate ventilation of the room when the range hood is used at the same time as appliances burning gas or other fuels (not applicable to appliances that only discharge the air back into the room)
- Do not install above a cooker with a high level grill.
- Do not leave frying pans unattended during use because overheated fats or oils might catch fire.
- Never leave naked flames under the cooker hood.
- If the cooker hood is damaged, do not attempt to use.
- This appliance is not intended for use by persons (including children) with reduced physical, sensory or mental capabilities, or lack of experience and knowledge, unless they have been given supervision or instruction concerning use of the appliance by a person responsible for their safety.
- Children should be supervised to ensure that they do not play with the appliance.
- If the supply cord is damaged, it must be replaced by the manufacturer, its service agent or similarly qualified persons in order to avoid a hazard.
- This appliance can be used by children aged from 8 years and above and persons with reduced physical, sensory or mental capabilities or lack of experience and knowledge if they have been given supervision or instruction concerning use of the appliance in a safe way and understand the hazards involved. Children shall not play with the appliance. Cleaning and user maintenance shall not be made by children without supervision
- The instructions shall state the substance of the following:
 - There shall be adequate ventilation of the room when the range hood is used at the same time as appliances burning gas or other fuels

- The details concerning the method and frequency of cleaning;
- There is a fire risk if cleaning is not carried out in accordance with the instructions
- Do not flambé under the cooker hood.
- CAUTION: Accessible parts may become hot when used with cooking appliances.
- The exhaust air must not be discharged into a flue that is used for exhausting fumes from appliances burning gas or other fuels (not applicable to appliances that only discharge the air back into the room)
- The minimum distance between the supporting surface for the cooking vessels on the hob and the lowest part of the range hood. (When the range hood is located above a gas appliance, this distance shall be at least 65 cm
- Regulations concerning the discharge of air have to be fulfilled.
- Clean your appliance periodically by following the method given in the chapter MAINTENANCE
- The installation instructions for range hoods with accessible metallic enclosures of class II construction shall include details that indicate the location and maximum permitted lengths for any fixing or mounting screw or other fixing device that penetrates into the range hood to attach an accessory such as a fascia or duct fitting.
- Where fixing or mounting screws, or other fixing devices are used, that penetrate into the range hood with an accessible metallic enclosure of class II construction, to attach an accessory, the instructions shall indicate the required location of these screws or fixing devices and include the substance of the following warning.
- Warning: Failure to install the screws or fixing device in accordance with these instructions may result in electrical hazards

INSTALLATION (VENT OUTSIDE)

If you have an outlet to the outside, your cooker hood can be connected as below picture by means of an given exhaust pipe or any suitable extraction duct (enamel, aluminum, flexible pipe or inflammable material with an interior diameter of 150mm)

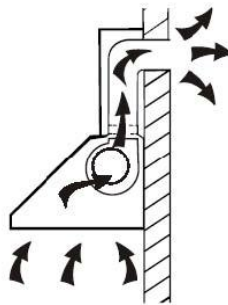

1. Before installation, turn the unit off and unplug it from the outlet.



2. The cooker hood should be placed at a distance of 70~80cm above the cooking plane for best effect.

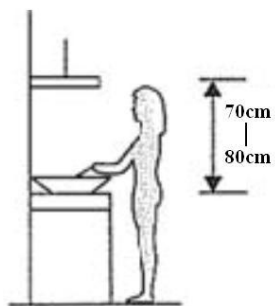

3. Screw **two** 4 x 40mm screws on the wall with wall plugs. Hang on the cooker on the two 4x 40mm screws.

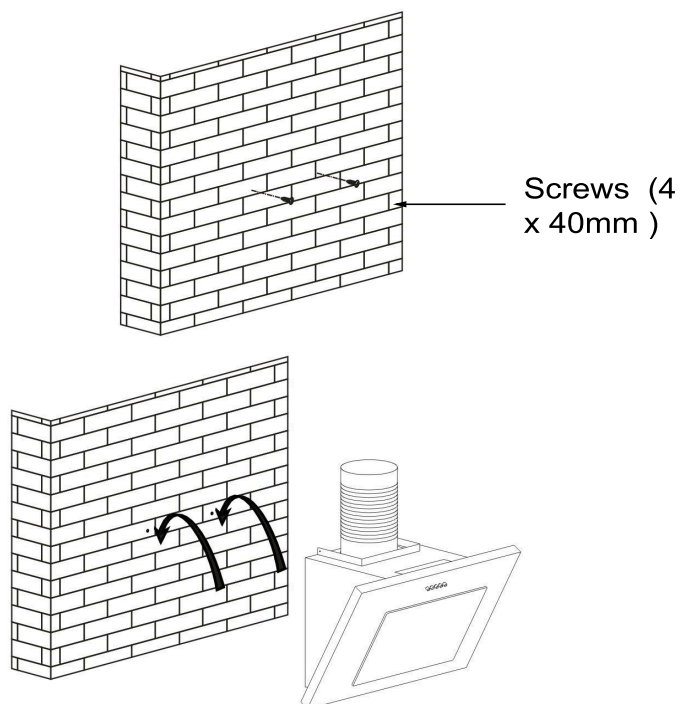

4. Also, fix the cooker hood on the wall by two 4x 30mm screws and wall plugs through the back of the cooker hood.

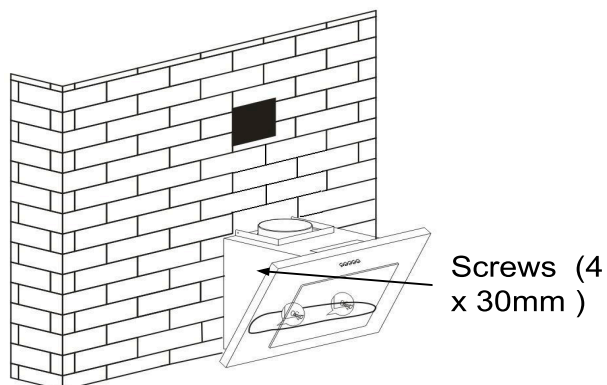

5. Attach the exhaust pipe on the way wall valve as shown below. Fix the exhaust pipe on the valve by cable tie.

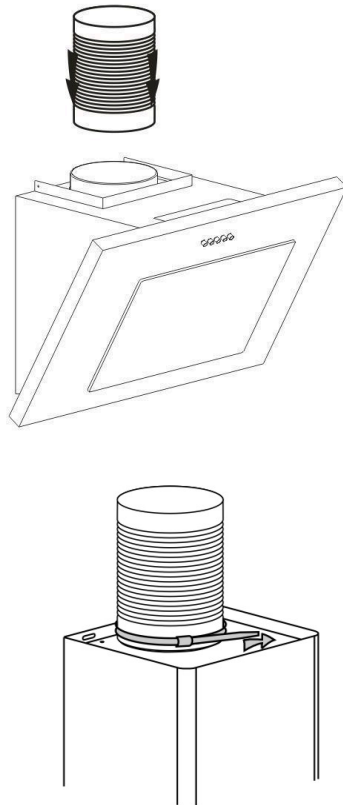

(6) Put the inner chimney on the outer chimney. Install plate 1 on the outer chimney by two screws (4mm x 8mm). Drill holes on the wall for fixing plate 1.

Note: Remember not to fix the screws (4mm x 8mm) too tight. 1mm loose is recommended so that later height adjustment can be done easily.

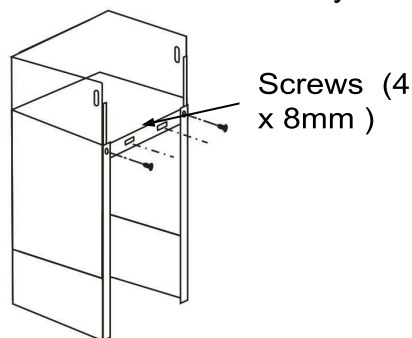

(7) Drill 2 holes to accommodate plate II. Screw and tighten plate II on the wall with the screws (4mm x 40mm) and wall plugs provided.

Remark: Plate II is used to fix the chimney. The below diagram is for reference. Fix the chimney to the wall plate is done in the end of installation.

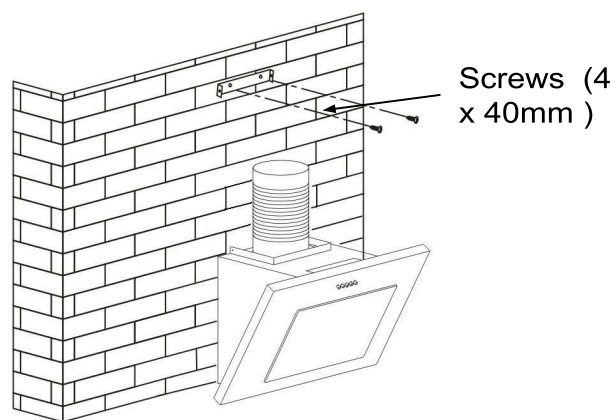

(8) Put the installed chimneys on the cooker hoods. Fix the plate I to the wall by using 2 (4mm x 40mm) screws and wall plugs. Lift up extension pipe till it out of the wall through the hole on the wall.

Lift up the inner chimney onto the plate II. Fix the inner chimney to the plate II by using 2 screws (4mm x 8mm). Fix the outer chimney to the cooker hood by using 2 screws (4mm x 8mm).

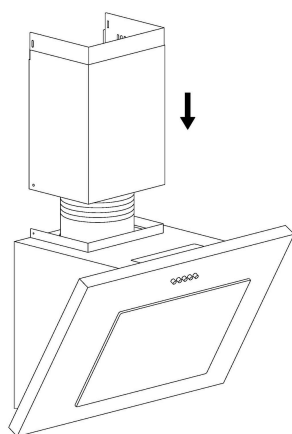

1

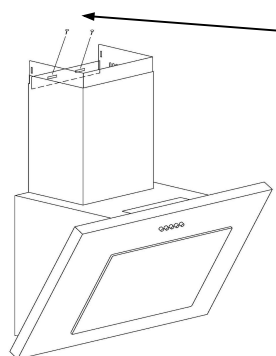

2

Screws (4 x 8mm)

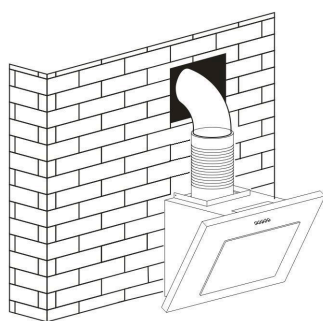

3

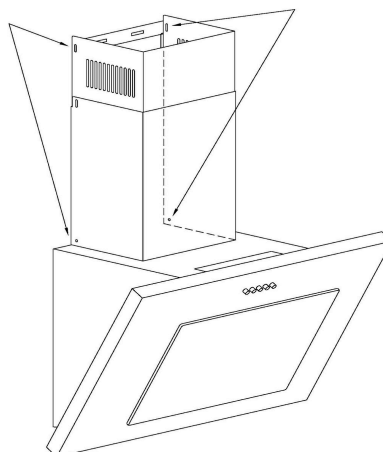

4

Carbon Filter

Activated carbon filter can be used to trap odors. Normally the activated carbon filter should be changed at three or six months according to your cooking habit. The installation procedure of activated carbon filter is as below.

1. In order to install the activated carbon filter, the aluminium filter should be detached first. Firstly open carefully the stainless steel cover, then press the lock of aluminium filter and remove it.

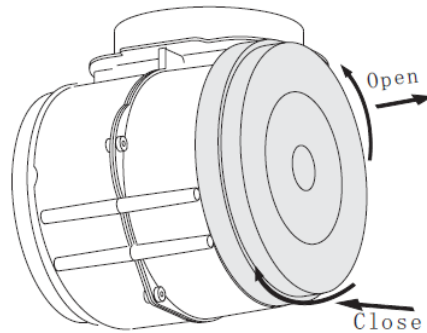
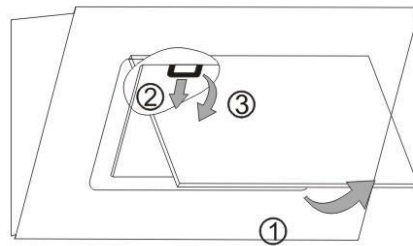

NOTE:

- Make sure the filter is securely locked. Otherwise, it would loosen and cause dangerous.
- When activated carbon filter attached, the suction power will be lowered.

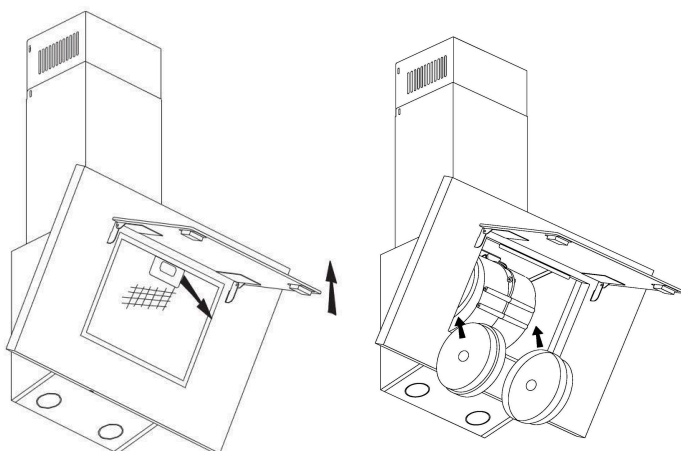

OPERATION

Off button **0**

Press this button to turn off the motor

Low Speed button

Press this button to operate at low speed.

Medium Speed button

Press this button to operate at medium speed.

High Speed button

Press this button to operate at high speed.

Light button

Press once, two lighting lamps will illuminate. Press again will turn all light off.

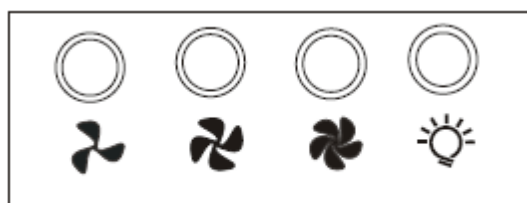



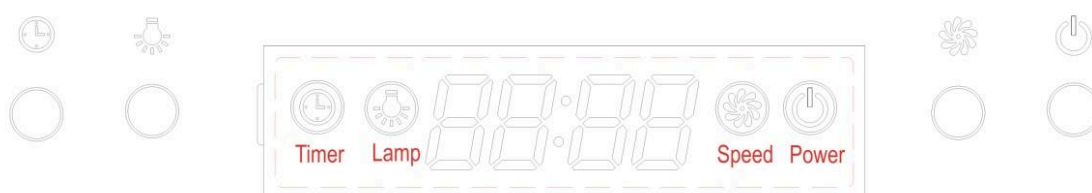

Pic. 11





1. Plug the hood; LCD will display 24-hour system with blue backlight. Backlight will be extinguished after 30 seconds without any operation.



2. Press " " button once; lights will be on and LCD will show "**Lamp**". Press " " button again; lights will be off and "**Lamp**" on LCD will disappear.













3. Press " " button once; the hood works at LOW speed and LCD will show "**Speed**" and " " button will be on. Press " " button again; the hood works at MEDIUM speed. Press " "



button one more time; the hood works at HIGH speed. Press “” button again; the hood works at LOW speed again and it repeat. While pressing “” button; the “” button is always on. If you want to stop the hood now; press the “” button once.



4. When the hood is not working; press “” button once. The hood will work at the speed it

works last time and LCD will show “ Speed”. Press “” button again; the hood stop working and “ Speed” will disappear from LCD.









5. When both “” button and “” button don’t work; “” button is used for time-setting.



Press “” button for 2 to 3 seconds;  will be shown on LCD and  flashes; which represents hour. Press “” button once the number adds by 01. Continue pressing “” button; it will display from 13;14... until 23. When LCD shows 23; it doesn’t work by pressing “” button. Press “” button once; the number reduces by 01. When LCD shows 00; it doesn’t work by pressing “” button. After setting hour; you can start setting minute by pressing “” button again.  on LCD flashes; which represents minutes. Press “” button once the number adds by 01. Continue pressing “” button; it will display from 01;02... until 59. When LCD shows 59; it doesn’t work by pressing “” button.

Press “” button once; the number reduces by 01. When LCD shows 00; it doesn’t work by pressing “” button. After setting hour and minute; press “” to confirm.

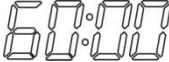
When “” button doesn’t work; “” button is used for delay timer function. Delay timer function allows you to set the hoods automatically power off according to the delay timer you set from 1

minute to 60 minutes. Press “” button once; it enters for delay timer setting and LCD shows

. Press “” button once the number adds by 01. Continue pressing “” button; it will display from  ;  ;  ... until  Press “” button

once; the number reduces by 01. After setting delay timer you want; press “” button to confirm. If you set delay timer as 05:00; the LCD display will show from 05:00; 04:59... until 00:01 00:00. When LCD shows 00:00; the hood will automatically power off and LCD display will only show 24-hour system with blue backlight. After 30 seconds without operation; blue backlight will disappear. But please note the Lamp is not under control of delay timer. Next time; if you want to use delay timer function and you press “” button without any change on time. The hood will automatically count time down from your previous setting after 5 seconds.

Bulb Replacement

1. Switch the unit off and pull out the plug first.
2. Wait until the light bulb is cooled down before replacement.

3. Replace with the same type of bulb (GU10 40W) by pushing the bulb slightly and screwing in or out.

Remark:

Alternatively you can change the bulb from the inside of the cooker hood, take out the metal filter and have the bulb replacement from inside of the cooker hood.

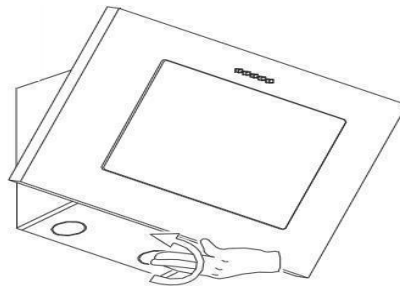

MAINTENANCE

Before cleaning, switch the unit off and unplug the appliance.

I. Regular Cleaning

Use a soft cloth moistened with hand-warm mildly soapy water or household cleaning detergent. Never use metal pads, chemical, abrasive material or stiff brush to clean the unit. Please select a suitable cleaning agent based on the material of the body.

The stainless steel must be cleaned regularly (e.g. weekly) to ensure long life expectancy. Dry with a clean soft cloth. A specialized stainless steel cleaning fluid may be used.

Note:

Ensure that wiping is done along with the grain of the stainless steel to prevent any unsightly crisscross scratching patterns from appearing.

The control panel can be cleaned using warm soapy water. Ensure the cloth is clean and well wrung before cleaning. Use a dry soft cloth to remove any excess moisture left after cleaning.

Important

Using neutral detergents and avoid using harsh cleaning chemicals, strong household detergents or products containing abrasives, as this will affect the appliance appearance and potentially remove any printing of artwork on the control panel and will void manufactures warrantee.

II. Monthly Cleaning for metallic anti-grease filter

ESSENTIAL: Clean the filter every month can prevent any risk of fire.

The filter collects grease, smoke and dust..... so the filter is directly affecting the efficiency of the cooker hood. If not cleaned, the grease residue (potential flammable) will saturate on the filter. Clean it with household cleaning detergent.

ENVIRONMENTAL PROTECTION

Waste electrical products should not be disposed of with household waste. Please recycle where facilities exist. Check with your Local Authority or retailer for recycling advice.

